

FOR ANIMAL TREATMENT ONLY



# MAGNESIUM CAPSULES

Each capsule contains: 210g MAGNESIUM ALLOY (equivalent to 189g MAGNESIUM) and 26g NATURAL RUBBER  
 Rumetrace® Magnesium Capsules are an aid in the prevention of grass tetany/staggers (hypomagnesaemia) in lactating cattle.  
 Each capsule provides supplementary magnesium for 9-12 weeks.  
 Net Contents: 40 capsules. Net Weight: 9.44kg



#### DIRECTIONS FOR USE

##### Contraindications:

This product is not to be used in cattle less than five months of age.

##### Dosage and Administration:

##### When to Dose

It is recommended to dose cattle 7-10 days before the grass tetany/staggers risk period begins.

##### Which Animals to Dose

Lactating cows in their second and subsequent calvings are at greatest risk.

##### Dosing Instructions

- Write the cow's eartag number onto the capsule with a permanent marker pen in case a capsule is regurgitated soon after dosing.
- Restrain the cow quietly. Placing the cow in a crush and getting an assistant to hold the head is usually necessary.
- Ease the applicator into the mouth until the capsule is at the back of the tongue then wait for the cow to swallow. As the cow swallows progress the applicator and capsule gently down the oesophagus.

- Only progress the applicator and capsule over the back of the tongue as the cow swallows. Do not release the capsule at the back of the tongue.
- Fully insert the applicator so that the capsule is well into the oesophagus before releasing the capsule.
- Release the capsule and remove the applicator after the animal has swallowed several times. Delaying the removal of the applicator from the mouth will stimulate swallowing to aid transport of the capsule to the rumen.
- Keep stock in the yard for 15-20 minutes to check that no capsules are regurgitated.

#### FOLLOW DOSING INSTRUCTIONS CAREFULLY FOR SAFE ADMINISTRATION

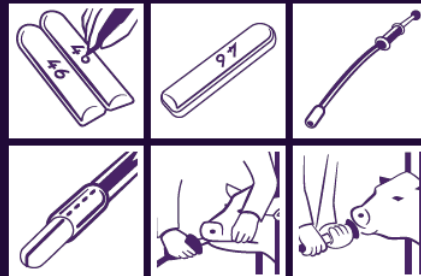

#### General Directions:

##### Further Treatment

Should the grass tetany/staggers risk period continue 10 weeks after the initial administration, animals should be given another capsule for further protection. Yarded cattle may be given other treatments (e.g. drenching, vaccination or pour-on lice controls) at the same time as these treatments should not interfere with the magnesium capsule treatment.

The capsules must only be administered using the Rumetrace® Magnesium Capsule applicator.

##### Note

Capsule release rates are influenced by animal feed intake and individual cow magnesium metabolism. For lactating cattle with heavier demands for magnesium (such as high producing dairy cattle) the use of other magnesium supplements may be required. Supplements could include blocks with magnesium and sodium. Coarse rock salt in conjunction with the capsules may be valuable.

Consult the Ridley AgriProducts or AgriHealth NZ hypomagnesaemia technical bulletins for further information. Carefully read the dosing instructions on the front panel before administration.

#### WITHHOLDING PERIODS

Zero (0) days.

#### TRADE ADVICE

**EXPORT SLAUGHTER INTERVAL: Zero (0) days.**  
 Before using this product, confirm the current ESI from Ridley AgriProducts Pty Ltd on 1300 666 657 or the APVMA website ([www.apvma.gov.au/residues](http://www.apvma.gov.au/residues)).

#### FIRST AID

If poisoning occurs, contact a doctor or Poisons Information Centre. Phone Australia 13 11 26 or New Zealand 0800 POISON (0800 764 766).

#### DISPOSAL

Puncture or shred and bury empty container in a local authority landfill.  
 If no landfill is available, bury the containers below 500 mm in a disposal site specifically marked and set up for this purpose clear of waterways, vegetation and roots.  
 Empty containers and product should not be burnt.

#### STORAGE

Store below 30°C (room temperature).  
 Store capsules under dry conditions to prevent deterioration.

KEEP OUT OF REACH OF CHILDREN.

**THIS PRODUCT DOES NOT CONTAIN RESTRICTED ANIMAL MATERIAL.**

**THIS PRODUCT DOES NOT CONTAIN MAMMALIAN MATERIAL.**

#### CONDITIONS OF SALE:

The use of this product being beyond the control of the manufacturer, no warranty is given and none shall be implied as to any consequences whatsoever arising from the use of this product.

**Manufactured by:** Ridley AgriProducts Pty. Ltd.  
 Level 9, South Tower Rialto, 525 Collins Street  
 Melbourne VIC 3000 Australia  
 Phone: +61 1300 666 657

#### NEW ZEALAND INFORMATION:

By New Zealand law the user must take due care, obtaining expert advice when necessary, to avoid unnecessary pain and distress.

Australia's Trade Advice and Export Slaughter Interval information do not apply in New Zealand.

Registered pursuant to the ACVM Act 1997, No. A010958

See [www.foodsafety.govt.nz](http://www.foodsafety.govt.nz) for registration conditions.

Registered in NZ to: Ridley AgriProducts Pty Ltd  
 Marketed in NZ by: AgriHealth NZ Ltd,  
 phone: 0800 821 421, [www.agrihealth.co.nz](http://www.agrihealth.co.nz)



**rumetrace<sup>®</sup>**  
**MAGNESIUM**  
**CAPSULES**

401896

APVMA Approval No. 52793/106728

Carton Number:

Expiry Date:

Batch Number:



Rumetrace<sup>®</sup> & the Rumetrace logo are registered trademarks of Ridley AgriProducts Pty. Ltd.