

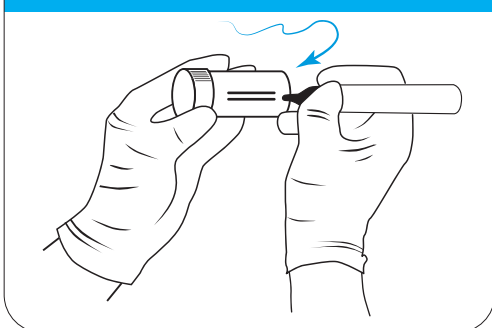

HOW TO TAKE A MILK SAMPLE

1. RECORD



Record cow number, quarter and date on the milk sample pottle. Use clean gloves

2. CLEAN TEAT



Scrub each teat end with a teat wipe or cotton wool ball soaked in 70% meths. Use new wipe / cotton ball until clean

3. PREPARE



Remove lid from the pottle, taking care not to touch inside of the lid or pottle. Hold lid between thumb and finger

4. DISCARD

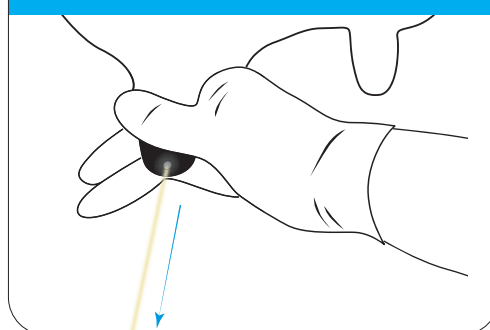

Discard the first 2 to 3 squirts of milk

5. COLLECT

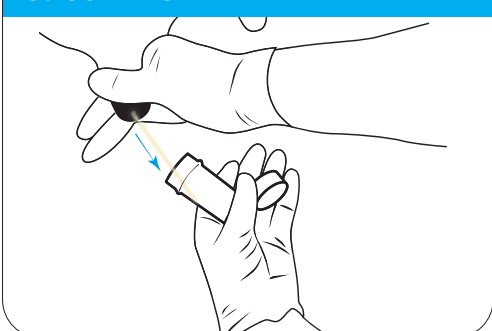

Hold pottle at 45 degree angle and half fill pottle with milk. Affix lid. Treat every clinical mastitis case with pain relief to reduce inflammation e.g. KetoMax

6. START TEST OR REFRIGERATE

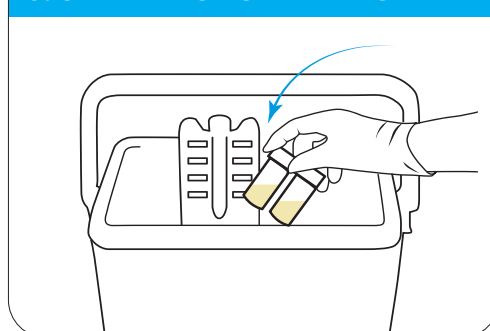

Start Mastatest the same day, or alternatively refrigerate sample and test later

Scan the QR Code to go to a series of Mastatest how to videos including registration, set-up and how to use Mastatest



HOW TO RUN A CLINICAL TEST - NZP2/NZP4

1. OPEN

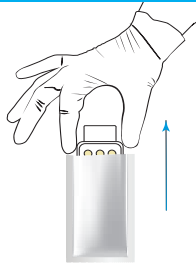

Wearing clean gloves, remove cartridge from the foil



2. ADD MILK SAMPLE

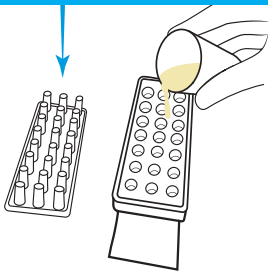

Remove lid and place lid upside down (ensure you do not touch the plungers). Fill the mastatest with milk until half full

3. DISCARD SURPLUS MILK

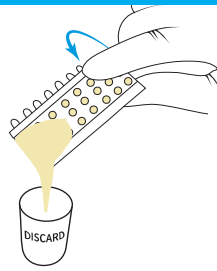

Pour off surplus milk, and discard. Do not put surplus back into milk sample

4. REPLACE LID

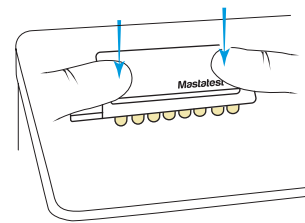

Replace lid (ensuring it is centered) and push down firmly onto bench. Write the cow number on the lid of the cartridge

5. TAP FIRMLY

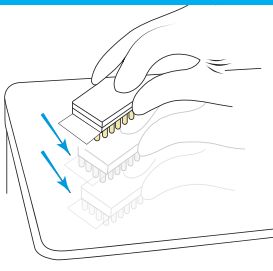

Tap the cartridge firmly onto the bench 3 to 4 times to ensure the milk goes into the bottom of the wells

6. INSERT CARTRIDGE

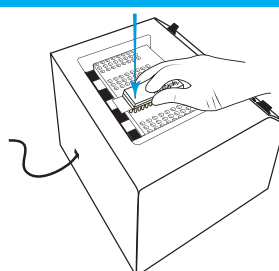

Insert into Mastatest lapbox with QR code label facing down and towards the back of the lapbox so the arrows on the cartridge match the arrows indicated on lapbox

7. START THE TEST



To Navigate the Mastatest Menu and run the test, refer to page 4 'How to start a test on a lapbox'

It is important not to contaminate the milk sample. Always wear clean gloves when working with mastitic cows and milk. Keep all work surfaces clean by wiping with teat wipes.



HOW TO RUN A SUBCLINICAL TEST - HiSCC

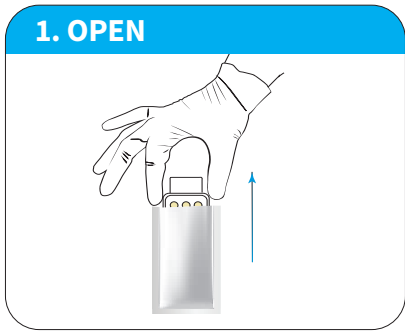

1. OPEN
Wearing clean gloves, remove cartridge from the foil

A HiSCC test cartridge can test two milk samples. Samples are separated by a partition in the centre. The two test chambers in the cartridge are labelled with a number (1 or 2) on the lid.

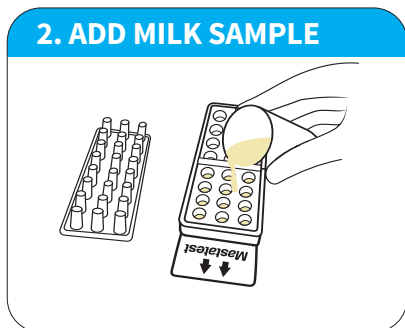

2. ADD MILK SAMPLE
Remove lid and place upside down (careful not to touch the plungers). Add milk sample to chamber 1 until wells are completely covered

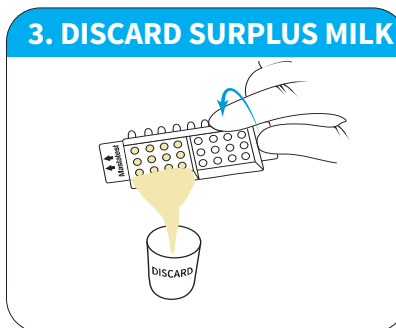

3. DISCARD SURPLUS MILK
Pour off surplus milk by tilting sideways. Ensure milk sample does not enter chamber 2

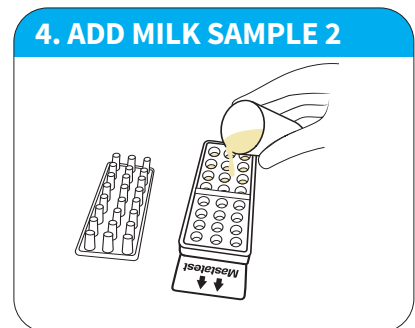

4. ADD MILK SAMPLE 2
Add a second milk sample to chamber 2 until wells are completely covered

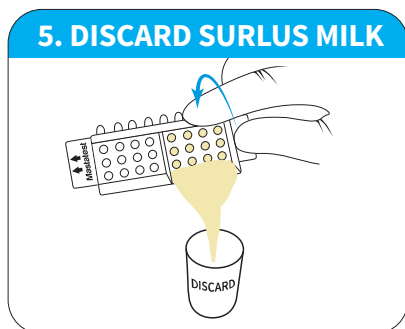

5. DISCARD SURPLUS MILK
Pour off surplus milk by tilting sideways. Ensure milk sample does not enter chamber 1

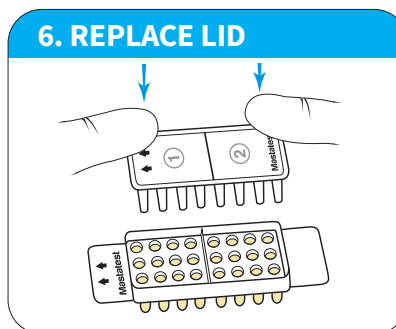

6. REPLACE LID
Line up arrows on lid with arrows on the base. Ensure lid is centered, and push down firmly on the bench

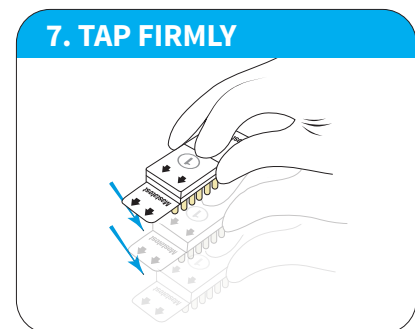

7. TAP FIRMLY
Tap the cartridge firmly onto the bench 3 to 4 times to ensure milk goes into the bottom of the wells

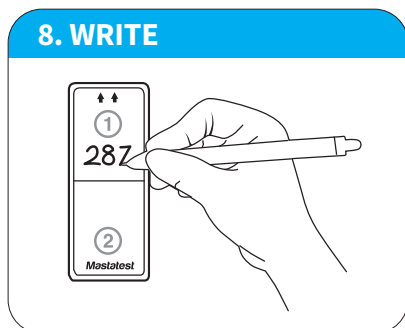

8. WRITE
Write cow numbers on lid. Ensure cow number corresponds to milk sample in chambers 1 and 2

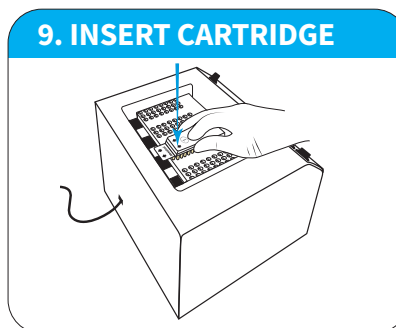

9. INSERT CARTRIDGE
Insert into Mastatest lapbox with QR code label facing down and toward the back of the box so the arrows on the cartridge match the arrows indicated on the lapbox

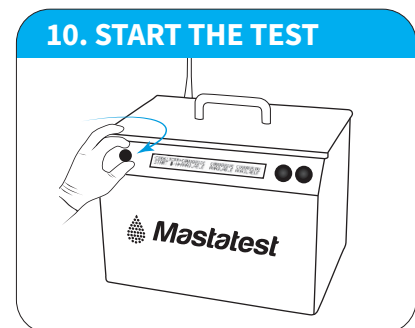

10. START THE TEST
To Navigate the Mastatest Menu and run the test, refer to page 4 'How to start a test on a lapbox'

HOW TO START A TEST ON A LAPBOX

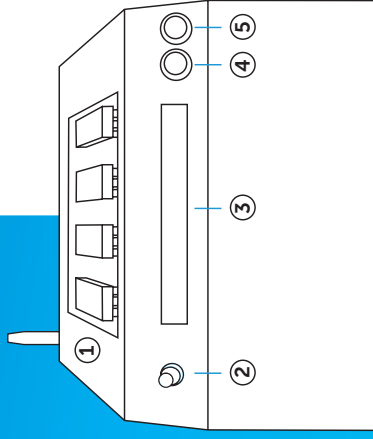

- ① Test slots
- ② Twist to scroll
Push to select
- ③ Display
- ④ Back button ←
- ⑤ Forward button →

→ Mastatest
Start Mastatest: Clinical or HiSCC

Select available slot



Clinical cartridge
(NZP2/NZP4)



HiSCC twin cartridge

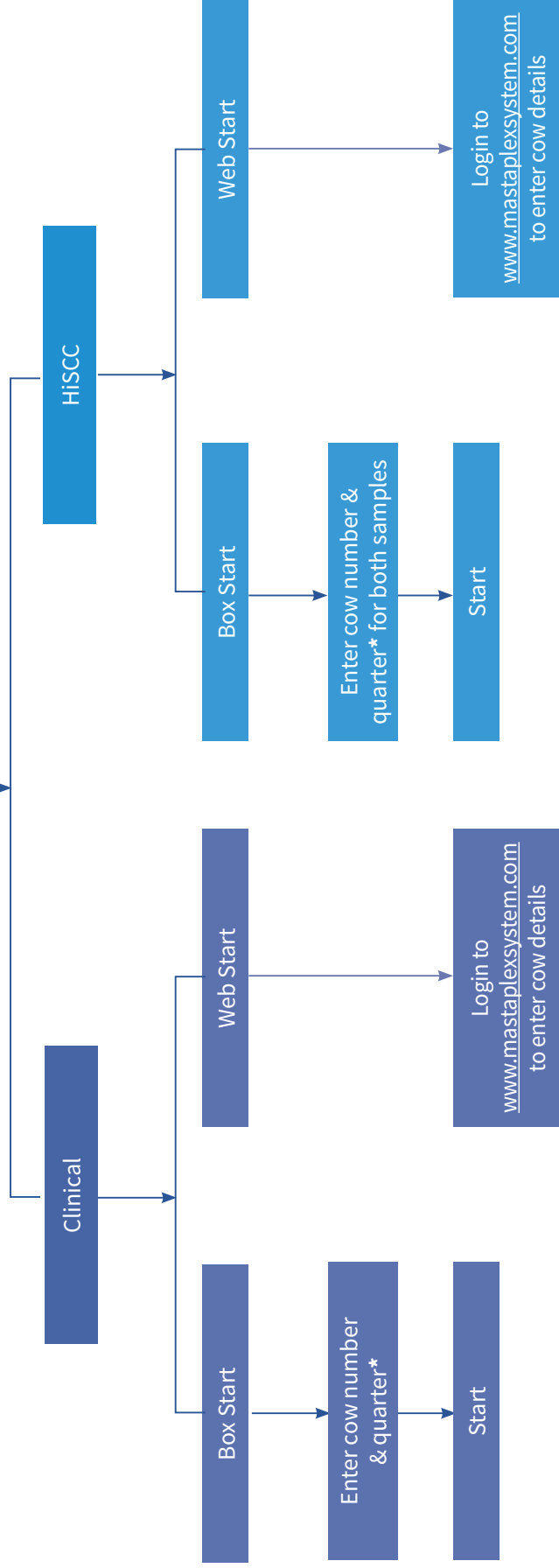

* If you are unsure which quarter or it's a pooled sample from multiple quarters leave this entry blank



Evidence based vet medicines

0800 821 421

www.agrihealth.co.nz

AgriHealth

HTA4-MASTA-4-2022