

## 1. HOW TO TAKE A MILK SAMPLE

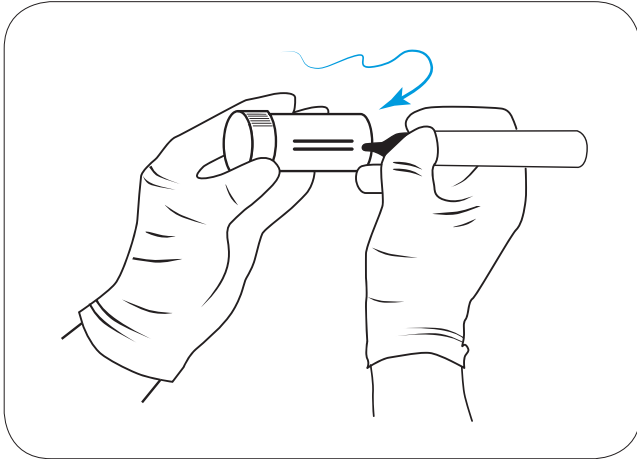

### 1. RECORD

Record cow number, quarter and date on the pottle. Use clean gloves

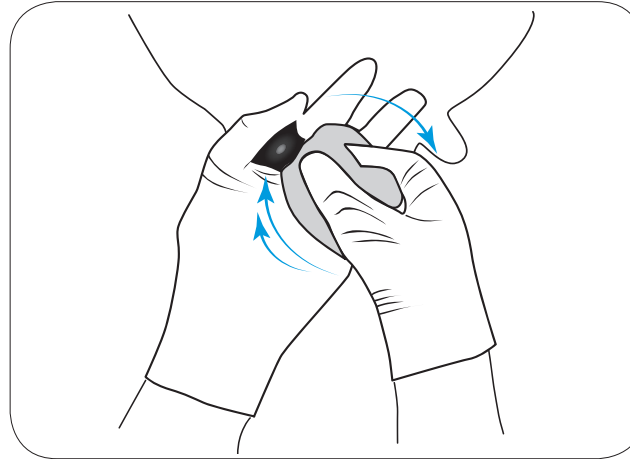

### 2. CLEAN TEAT

Scrub each teat end with a teat wipe or cotton wool ball soaked in 70% meths. Use new wipe / cotton ball until clean

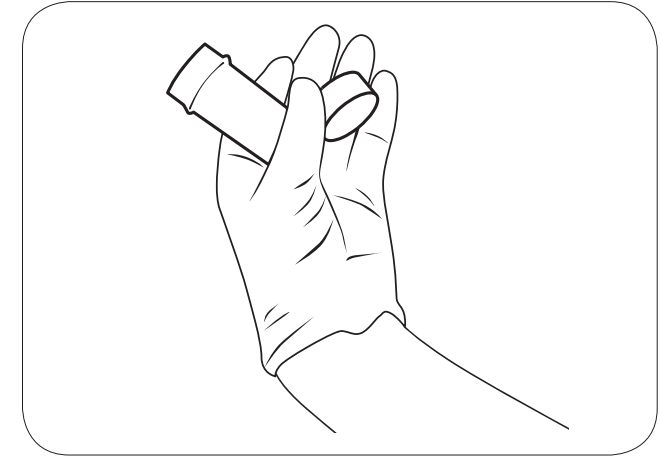

### 3. PREPARE

Prepare tube. Remove lid, taking care not to touch inside of the lid or tube. Hold lid between thumb and finger

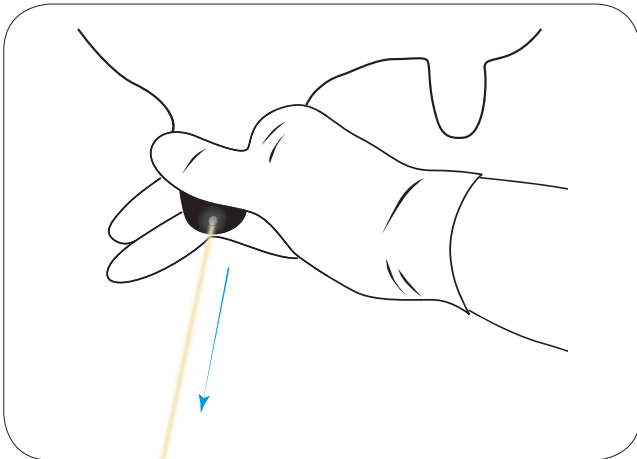

### 4. DISCARD

Discard the first 2 to 3 squirts of milk

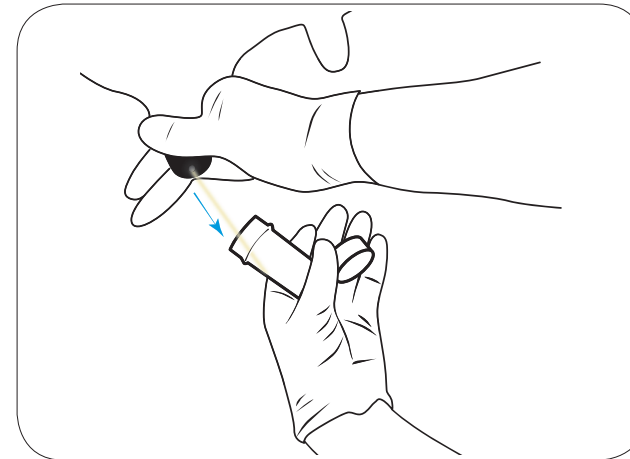

### 5. COLLECT

Hold pottle at 45 degree angle and half fill pottle with milk. Affix lid

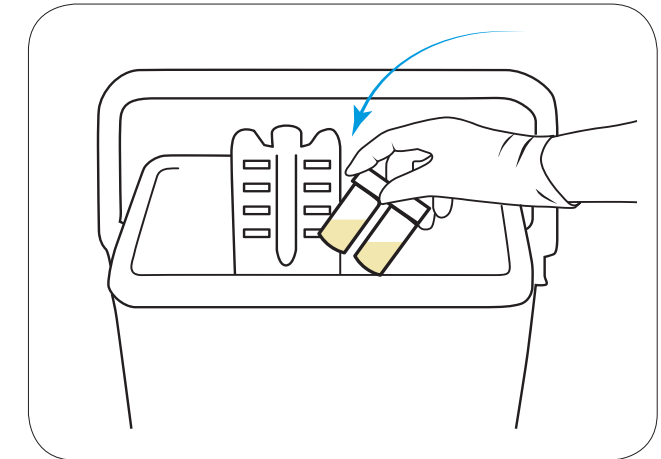

### 6. START TEST OR REFRIGERATE

Start Mastatest the same day, or alternatively refrigerate sample and test later

## 2. HOW TO RUN MASTATEST

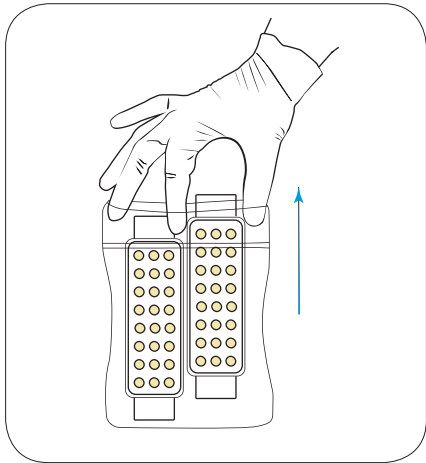

### 1. OPEN

Wearing clean gloves, remove cartridge from bag

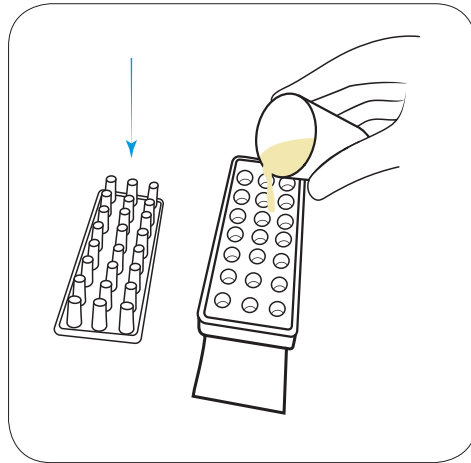

### 2. ADD MILK SAMPLE

Remove lid and place lid upside down (ensure you do not touch the plungers). Fill the mastatest with milk until half full

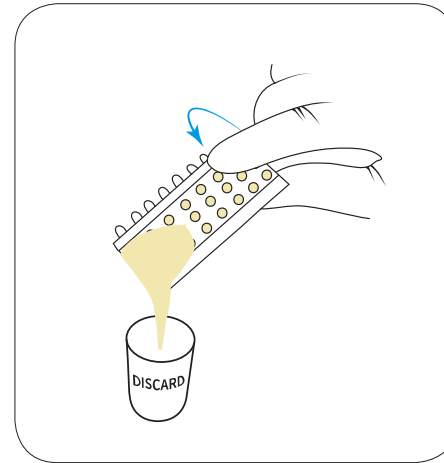

### 3. DISCARD SURPLUS MILK

Pour off surplus milk, and discard. Do not put surplus back into milk sample

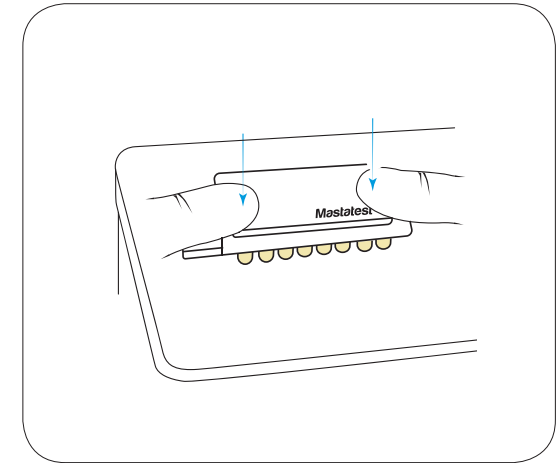

### 4. REPLACE LID

Replace lid (ensuring it is centered) and push down firmly onto bench

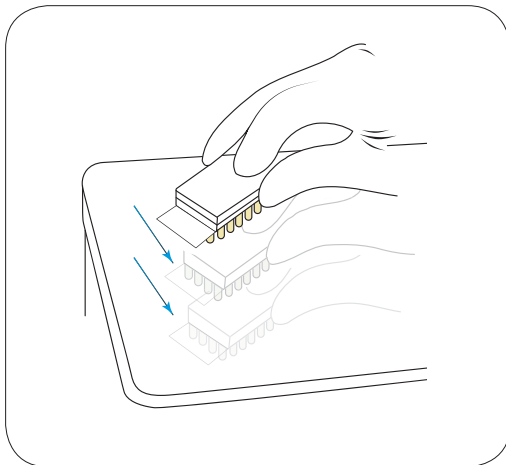

### 5. TAP FIRMLY

It is important to tap firmly, twice

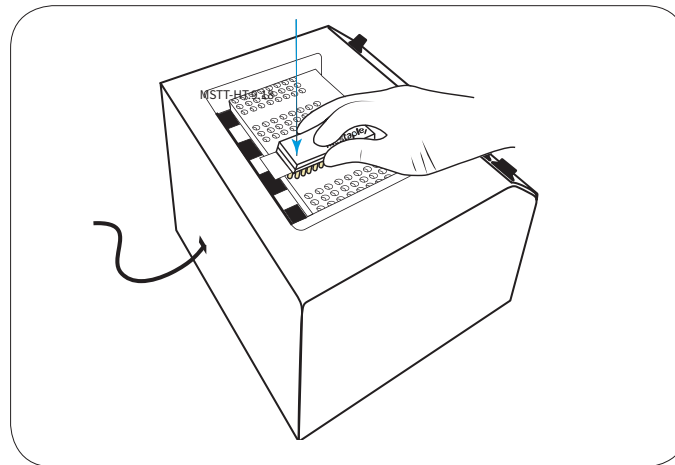

### 6. INSERT CARTRIDGE

Insert into Mastatest lapbox with QR code label facing down and toward the back of the lapbox

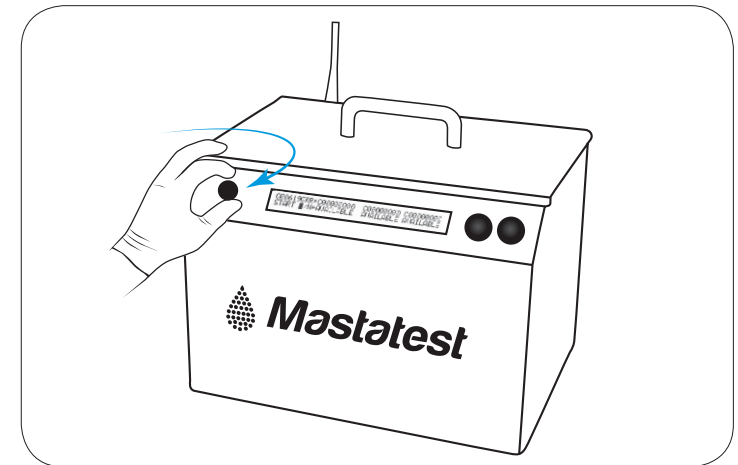

### 7. START

Dial in the cows number. Press enter to start test. Results sent via email within 24 hours

It is important not to contaminate the milk sample. Wear clean gloves. Keep all work surfaces clean by wiping with teat wipes



Evidence based vet medicines

AgriHealth